

PUG / dry mix system

The PUG / dry mix - Uses readily available and familiar materials, making it a simple and cost-effective method of maximising the heat output.

The system is installed from above, and can either be laid within the floor construction, or between battens above an existing floor where height permits.

An 8:1 dry PUG sand and cement mix is laid around the pipes which provides good surface contact and thermal storage. The pipes can be run at centres to suit the joists or battens, giving you a simple and versatile installation.

Depending on the available build height, the system can incorporate insulation directly below the pipe system or below the deck, allowing for the design and performance requirements of the building. The pipes can be clipped using EasyFix™ staples or EasyFix™ P-clips.

Key system characteristics:

- Simple installation
- Familiar and available components
- Versatile installation
- New build or retrofit solution
- Provides good thermal capacity in suspended floors
- Versatile pipe layout and pipe density

Key components:

- EasyFix™ staples or EasyFix™ P-clips
- SUPERflex™-16 / AluPlus®-16 pipe
- Manifold and water controls
- Thermostats and wiring centres

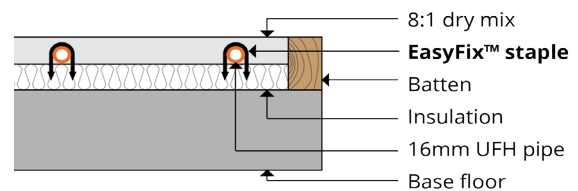
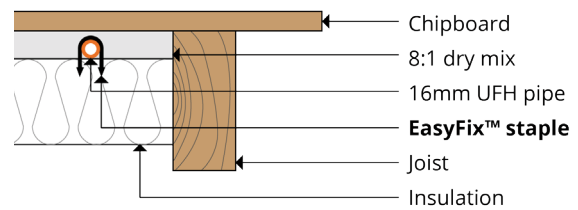
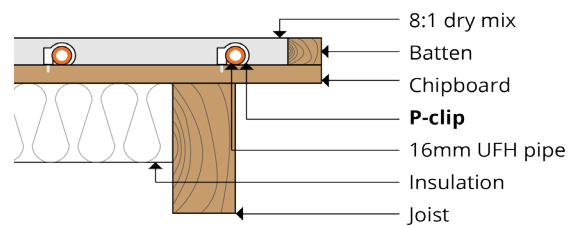

Heat output

250mm pipe centres	40W/m ² to 50W/m ²
200mm pipe centres	50W/m ² to 60W/m ²
150mm pipe centres	60W/m ² to 70W/m ²

*Outputs shown are approximate, depending on room temperature and floor covering. This range typically delivers the flow temperature with a chipboard coverboard and 1 tog floor covering. Based on a flow temperature of 55°C to 60°C.



About us

No ifs, no buts. The award-winning Continal® service means you get an underfloor heating system delivered to you on time, on site, every time, no compromise.