

## Solid floor / screed system

The Continal® screed system - Quick and easy, familiar to the installer and cost-effective.

The most common method of fitting underfloor heating, suitable for new builds and renovations where a new screed floor is being laid. Using our trusted SUPERflex™-16 or AluPlas®-16 UFH pipe and our Continal® fitting systems.

Whether you use Continal® staples, SpeedTrak® or pipe ties, you can be safe in the knowledge that this screed system will get the job done, be fast to install, and give the outputs the customer wants.

### Key system characteristics:

- Easy to install
- Most cost-effective solution
- Variety of screed depths
- Familiar to the builder
- No specialist equipment required

### System options:

- SUPERflex™-16 or AluPlas®-16 pipe
- Continal® staples
- Continal® pipe ties
- Continal® SpeedTrak®

### Key components:

- SUPERflex™-16 or AluPlas®-16 pipe
- Continal® edge insulation
- Pipe fixing method of your choice
- Manifold and water controls
- Thermostats and wiring centres

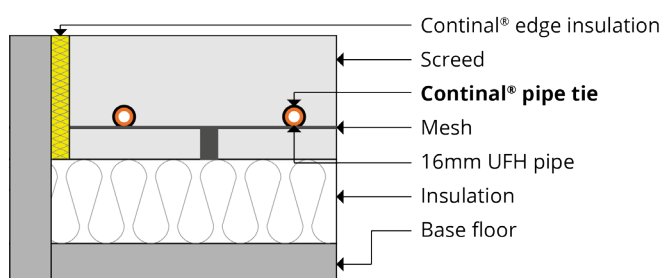
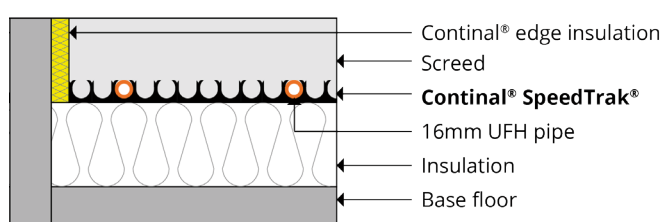
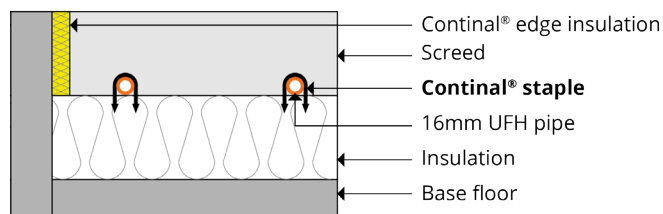

### Heat output

250mm pipe centres	50W/m <sup>2</sup> to 60W/m <sup>2</sup>
200mm pipe centres	65W/m <sup>2</sup> to 75W/m <sup>2</sup>
150mm pipe centres	75W/m <sup>2</sup> to 90W/m <sup>2</sup>

\*Outputs shown are approximate, depending on room temperature and floor covering. This range typically delivers the flow temperature with a standard screed and 1 tog floor covering. Based on a flow temperature of 45°C to 50°C.

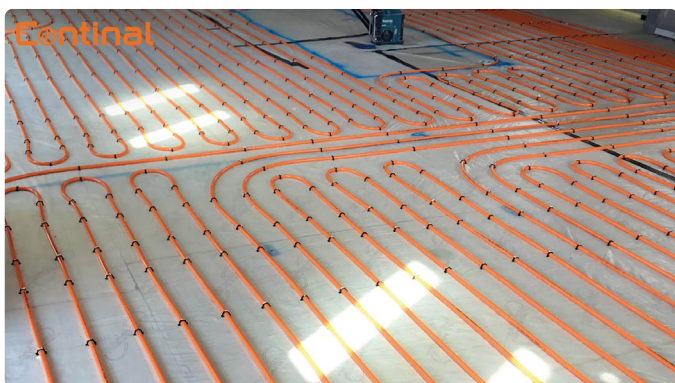

### About us

No ifs, no buts. The award-winning Continal® service means you get an underfloor heating system delivered to you on time, on site, every time, no compromise.