

Continal® pumpset mixer

The Continal® pumpset mixer provides accurate “on manifold” water temperature control to heating circuits, and connects via ball valves to the manifold.

This is for systems where a high temperature heat source is used, and controls water temperature via the mixing valve to the design temperature required.



Features:

- Pre-assembled high efficiency pump unit
- Accurate TMV adjustable from 20°C to 55°C
- Compact design
- Nickel plated
- Connects to Continal® Manifolds via valve connections
- Built-in temperature gauge
- Unique swivel joint to allow left or right hand fitting

Technical:

- Dimensions: 311mm x 191mm x 133mm
- Inlet connections: 3/4" M / 22mm or 28mm
- Outlet connections: 3/4" M / 22mm or 28mm
- Manifold connections: 2 x G1"
- Valve body: kvs 3.4

Temperature:

- Operating temperature range: 20°C to 55°C
- Maximum temperature: 95°C

Pressure:

- Maximum static pressure: 10 bar
- Maximum differential pressure: 3 bar

Continal® pumpset: low temp

The Continal® pumpset: low temp is also available without the mixing valve, for use in situations where water temperature controls are not required. This is usually the case where heat pumps are used.

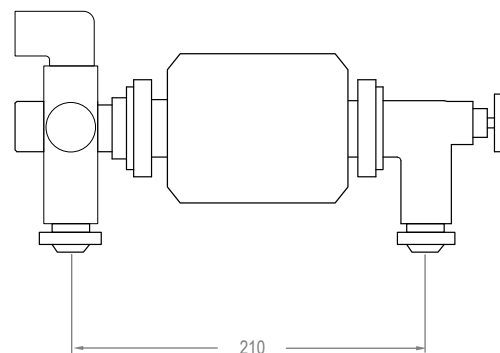

About us

No ifs, no buts. The award-winning Continal® service means you get an underfloor heating system delivered to you on time, on site, every time, no compromise.

