

OneBoard® is a unique structural underfloor heating system that replaces the normal chipboard or plywood on joisted floors.

It is a composite chipboard panel with heat dissipation foil giving excellent output and response time, and is suitable for all heat sources.



### Features:

- Structural timber floor system
- Low profile 22mm for minimal build height
- In-deck floor solution for suspended floors
- Tongue and groove for easy flat installation
- Low cost

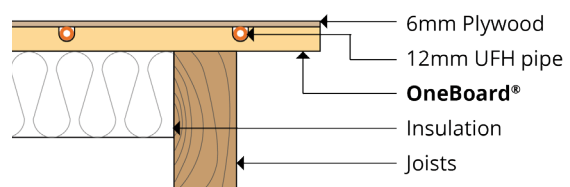
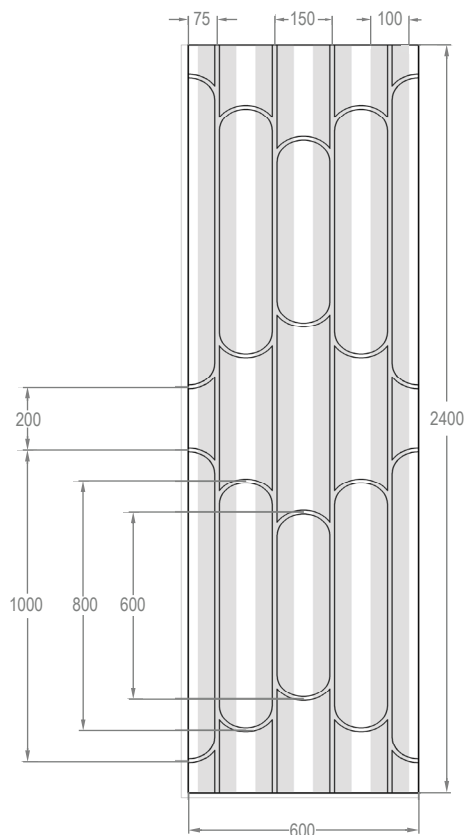

### Technical:

- Material: P5 grade chipboard
- Dimensions: 2400mm x 600mm x 22mm
- Pipe centres: 150mm
- Pipe channels: 12mm
- Panel weight: 22.5kg
- Edge profile: tongue and groove
- Foil diffuser: 50µm x 100mm
- Thermal conductivity: 0.14W/mK

### Other properties:

- Low emission grade E1 (Formaldehyde EN120) ≤8.0mg/100g
- Fire protection class: D

### Accreditations:

- Chipboard to BS EN 312
- TRADA tested to EN1195

## About us

No ifs, no buts. The award-winning Continal® service means you get an underfloor heating system delivered to you on time, on site, every time, no compromise.

